

 Create pdf

## Lampholders and starter holders

26.641.2101

### G5 End fixing lampholders



colour	pkg.	wt.	part no.
white	1000	4 g	26.641.2101.50

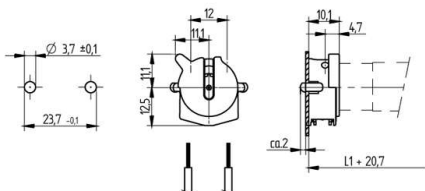

L1+ 20.7: Recommended dimension is based on use of one lampholder with and one lampholder without rotor rotation aid and thereof one lampholder with spring. The final distance should be governed by the dimensions of the respective lamps and luminaires.

Approval: additional cULus (120W / 600V)

Wiring: through the body







With rotor rotation aid

Snap in pins horizontal

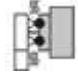
Housing: PC

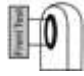
Rotor: PBT

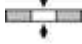
- Note: The lampholder with rotor rotational aid shown here, facilitates easy lamp change in slim light fittings. On request, each version with standard rotor is also possible with rotor rotation aid. Please contact us.
- For each pair of lampholders, a lampholder with rotor rotation aid can only be used on one side. In this instance at least one lampholder must be fitted with a leaf spring.

T 130	Tm 110					 18 AWG 0.5 - 1.0 mm <sup>2</sup>	 0.6 - 1.0	
-------	--------	---	---	---	--	--	--	---

Document generated on: Mo, 6. February 2017 - 11:50